

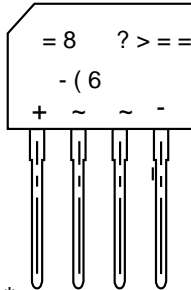

: 5 \* % 3

8OWUDVRIW 5HFRYHU\ %ULGJH



3, 11, 1\*

3, 1	'(6&5,37,21
	, Q S X V A A Q
	, Q S X V A A Q
	2 X W S X W A Q R G H
	2 X W S X W & A W K R G H

) HDWXUHV  
 ‡\* OD V DVVLYY DWLSC F W L R Q  
 ‡5HYHURD WDJH9  
 ‡)RUZDUGUHQW  
 ‡+LJXU&XUU&HSD ELOLW\  
 ‡'HVLJQRGXUIDRXSS/SOLFDWLRQ  
 %HQHILWV  
 ‡&DVH%3  
 ‡7HUPLGROGHBBB,OH67'

0D[LPXPDWLQOQGOHFWEKBD OFWHULVWLFV

5DWLQVf&PELMOHSHUXDQXUMKHU/S/HFLILHG  
 6LQJOH SKDVH KQOIHZDVRUQGXFORVDSHSDFLWEXHUOROVWH

3DUDPHWHU	6\PEROV	:5*%3	8QLWV
0D[LPXP 5HSHWLWLYH 3HDN 5954DU	VH 9ROWDJH		9
0D[LPXP 506 YROWDJH	9506		9
0D[LPXP '& %ORFNLQJ 9ROWDJH&			9
\$YHUDJH 5HFWLILHG 2XWSXW &RUUHQW			\$
5HYHUVH 5HFRYHU\ 7LPH ,) \$ ,5 \$ ,55 \$	7UU		XV
3HDN )RUZDUG 6XUJH &XUUHQW +DOI 6LQH :DYH 6XSHULPSRV,HC RQ 5DWHG /RDG -('(& 0HWKRG		PV 6LQJOH RQ 5DWHG	\$
, WUDWROXVVLQBV W PV	, W		\$ 6
0D[LPX)RUZDUG WDWH\$	9)		9
0D[LPXP '& 5HYHUVH &XUUHQW #7\$ DW 5DWHG '& %ORFNLQJ 9ROWDJH #7\$	f& f&		\$
7\SLFDO -XQFWLRQ&RVSDFLWDQ&MH			S)
2SHUDWLQJDQG 6WRUDJH 7HPSHW PSTW			f&
1RWH0HDVXDHC+]DQSSOLLHYGHYURQVWDJH&			



: 5 \* % 3

5 \$ 7 , 1 \* 6 \$ 1 ' & + \$ 5 \$ & 7 ( 5 , 6 7 , & 6 & 8 5 9 ( 6 X Q O H V V R W K H U Z L V H Q R W H G

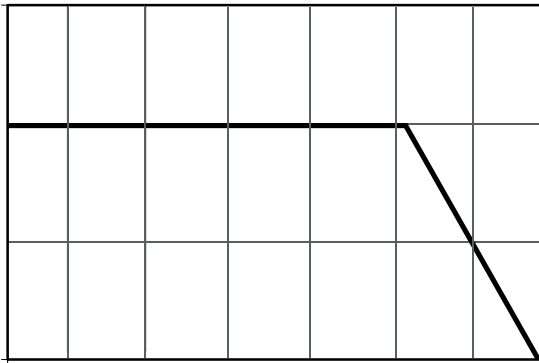

7 F & DVH<sup>R</sup> & 7 HPS

Current Derating

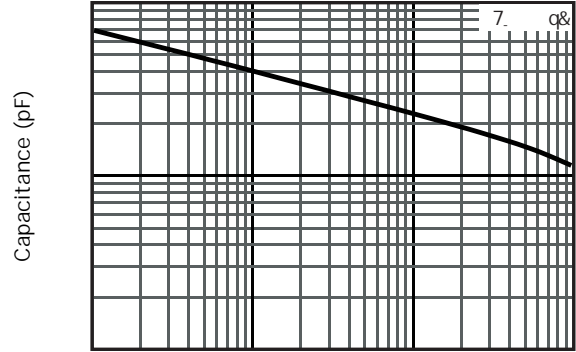

Reverse Voltage(V)

Typical Junction Capacitance

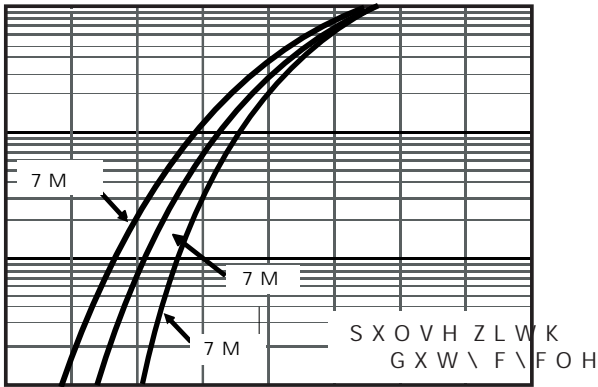

9 I , Q V W D Q W D Q H R R 0 W 0 W 7 D U G

Typical Forward Voltage

5 H Y H U V 1 0 \$ & X U U H O W

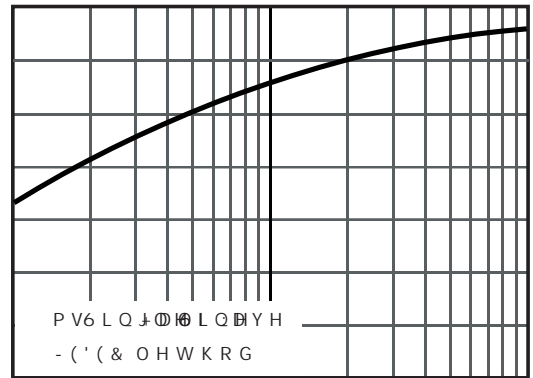

9 5 5 H Y H U V H 9 1 0 0 W W D J H

Typical Reverse Current

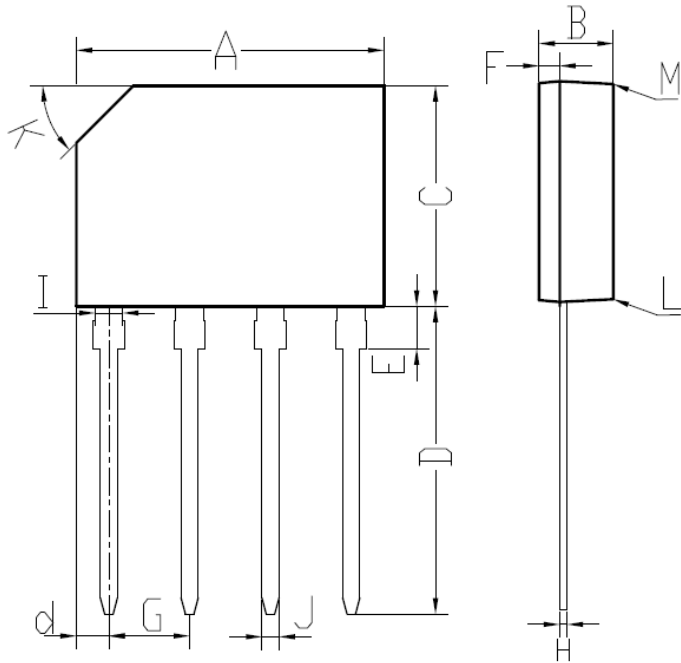

GBP		
DIM.	MIN.	MAX.
A	14.20	14.70
B	3.30	3.60
C	10.20	10.60
D	13.80	14.40
d	1.40	1.70
E	1.80	2.20
F	0.80	1.10
G	3.71	3.91
H	0.30	0.55
I	1.22	1.42
J	0.76	0.86
K	2.7 x 45 (Typ)	
L	#	3
M	#	2
All Dimensions in millimeter		